



**Recommended Use**

Parking Lots

**Specifications**

HRPO Steel Baseplate - Galvanized Steel Pole  
Aluminum Shear Away Bolts

Date: 9/8/2007

Size: ANSI A

Size: Sheet 1 of 1

Bolt (supplied with Expansion Plug)

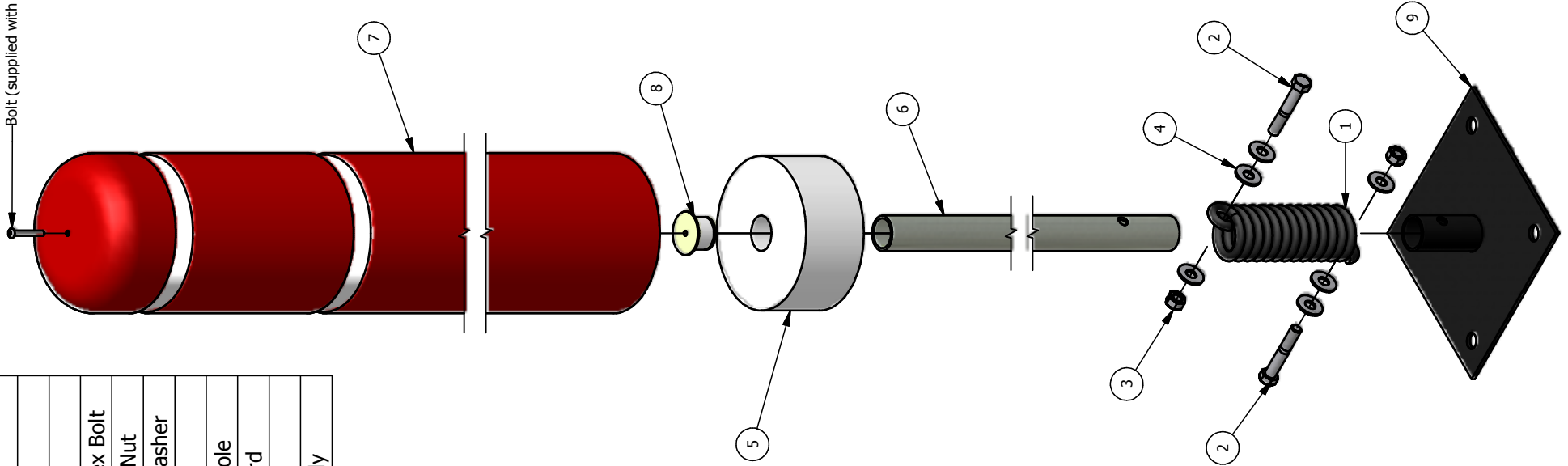

Flex Bollard Parts List

ITEM	QTY	DESCRIPTION
1	1	Torsion Spring
2	2	1/2" x 3" Aluminum Hex Bolt
3	2	1/2" Aluminum Hex Nut
4	6	1/2" Aluminum Hex Washer
5	1	Foam Ring
6	1	1 5/8" Galvanized Pole
7	1	Polyethylene Bollard
8	1	Expansion Plug
9	1	Baseplate Assembly